

POP

PRIVATELY OPERATED PAYPHONES

APS

ASSISTANCE TELEPHONES (EG ELEVATOR AND ROADSIDE PHONES)

MET

APPLY TO OTHER TYPE OF METERING POINT (any service)

ATM

ATM

PRK

BANDSTAND / ROTUNDA / SPORTS FIELD STANDS / OTHER PARK BUILDING

PSD

POINT OF SALE DEVICE (vending machine, ticket machine)

TRF

Traffic Lights / Traffic Light Controller / Variable Speed Sign / Traffic Signal

PBT

Public Transport (bus stop, tram stop, railway station, taxi rank, ferry wharf)

SWT

Links / Link Pole / MV / HV Links / ABC Links / Dynamic Switch / Airbrake Switch / Isolator

WAT

Water Infrastructure (storage, pumps, valves water supply, waste water, sewerage stations)

GAS

Natural Gas Infrastructure

CAM

Camera (security / traffic)

CTL

Bridge control, swing bridge, traffic control gates, railway boom gates)

MOB

Mobile Phone Tower / radio antenna

LIT

Street Lighting Pole / street light controller

CAR

Unmanned (council) car park

PWR

Transformer / Kiosk / Pad Mount Sub-station / Pole Mount Transformer

NAP-ID

N

Network Access Point (NAP)

MPT-ID

N

Multiport (MPT)
n is the number of ports (eg 4,6,8,12)

Penetration

CABLE TRAY:

STAFF WORKING ON THIS ESTIMATE PLEASE
NOTE: The location of other authorities services which may affect this work have not been obtained by the estimator. Constructor to obtain service information before commencing.



SAFETY FIRST
SAFETY STARTS WITH YOU

TJL-ID

Splice Joint on a Transit Cable (TJL)

DJL-ID

Splice Joint on a Distribution Cable (DJL)

LJL-ID

Splice Joint on a Local Cable (LJL)

MJL-ID

Splice Joint on a Tether Cable (MJL)

AJL-ID

Zone Terminal / Splice Joint (AJL)

FDH-ID

Fibre Distribution Hub-FDH Cabinet with Cabinet ID shown

PIT-ID

2

Service Drop Access Pit (650mmX280mmX565mm)

PIT-ID

5

Network Boundary/Local Network Pit (Single Lid) (700mmX450mmX650mm)

PIT-ID

6

Distribution/Local Network Connection Pit (Dual Lid) (1360mmX555mmX650mm)

PIT-ID

8

Distribution/Local Network Connection Pit (1360mmX555mmX860mm)

PIT-ID

9

Fibre Distribution Hub (FDH) Pit (2000mmX555mmX900mm)

Shared Trench

NTD

nbn NTD

OBBU

NBN Optional Battery Backup Unit

PDH

nbn Premises Distribution Hub

CTL

nbn Cable Transition Location

FDT

nbn Fibre Distribution Terminal

FIP

nbn NTD Fire Indicator Panel

Riser

Riser

LIFT

nbn NTD LIFT

AP

Access Panel

SEC

nbn NTD Security

CET

nbn Communications Earth Terminal

DES QTY

Example of descriptor box that will show the type of work and the quantity involved

nbn manhole

Existing Telstra manhole

FAN AAAA

Fan Access Node site (FAN)

138A^{RX}_{CX}

Multi Dwelling Unit (MDU)

DEPTH--
ALIGN--

DEPTH OVER ALIGNMENT SYMBOL TO BE USED WITH EVERY MARKER POST

Symbol to be used when replacing/removing existing network

PCD

Premise Connection Device (PCD)

POLE-ID

Pole (showing pole identity)

5

Existing Telstra Pit (2,3,4,5,6,7,8,9)
Telstra exchange

Example of Telstra Major Conduit Layout with Proposed duct marked to be used by NBN

M < - >

NBN MARKER POST
MARKER POST TO BE NUMBERED

CONDUIT CONFIGURATION

CONDUITS AND DUCTS ARE IN LAYER :
< L460 NBN Support - Underground >
AND TERMINOLOGY CATEGORIZED INTO TWO GROUPS IN THE DRAWING AS PER BELOW:
1- DUCT USED WITH LOCAL NETWORK
2-CONDUIT USED WITH LEAD-IN DROPS
ATTRIBUTES ATTACHED ARE AS SHOWN

CONDUIT SIZE

PIT-ID 9 P100

CONDUIT LENGTH

26.5 PIT-ID 5

CABLE CONFIGURATION

CABLE TYPE:
CABLES DIVIDE INTO FOLLOWING CATEGORIES AND ARE COLOUR CODED:
TRANSIT CABLES COLOUR NO: 1 312F
DISTRIBUTION CABLES COLOUR NO: 190 288F
LOCAL CABLES COLOUR NO: 4 144F
TETHER CABLES COLOUR NO: 3 12F
LEAD IN (DROP) CABLES COLOUR NO: 5 1F

CABLE SIZE:

CABLE SIZE IS THE TOTAL NUMBER OF OPTIC FIBRES IN THE CABLE AND IS DETERMINED BY A NUMBER FOLLOWED BY F (FIBRE) OR R (RIBBON) IN THE MIDDLE OF THE LINE TYPE

576F

CABLE LOCATION:

CABLE LOCATIONS DETERMINES WHERE THE CABLE IS USED AS PER BELOW:

IN-CONDUIT 288F
AERIAL 144F
BURIED 96F

LINE TYPES ARE CATEGORIZED INTO 3 TYPES:

1- IN-CONDUIT: (XXXXF) 312F , ...
2- AERIAL: (XXXXF_A) 144_A , ...
3- BURIED: (XXXXF_B) 12_B , ...

FSA Boundary
FSAM Boundary
FDA Boundary

PRELIMINARY

REV	DATE	DRAFTER	DESCRIPTION	APPROVED
-				
-				
-				
E.01	06/12/2023	CIPRIAN PASCU	PRELIMINARY - CADATRE LAYOUT UPDATED ROAD 9 & 10 REMOVED LID TO AMRF	NAME
D.01	20/11/2023	CIPRIAN PASCU	PRELIMINARY - PIT & PIPE AMENDED BOQ	NAME
C.01	07/09/2023	CIPRIAN PASCU	PRELIMINARY - PIT & PIPE AMENDED	NAME
B.01	15/08/2023	CIPRIAN PASCU	PRELIMINARY - UPDATED AS PER REF1	NAME
A.01	15/08/2023	CIPRIAN PASCU	PRELIMINARY	NAME

STRICTLY CONFIDENTIAL

NBNCO APPROVAL RECORD:

☐ DD

☐ WD

☐ AB

SIGNATURE

DATE

QUALITY RECORD :

NBNCO DISCLAIMER
THIS DOCUMENT HAS BEEN PREPARED SOLELY FOR THE USE OF NBNCO LIMITED (ABN 86 136 533 741) FOR USE IN MAINTAINING NBNCO FACILITIES. IT HAS NOT BEEN CREATED FOR ANY OTHER USE. IT SHOULD NOT BE SCALED TO LOCATE NBNCO ASSETS. NO WARRANTY IS GIVEN THAT THE INFORMATION IS ACCURATE OR COMPLETE.

DESIGN IT TELCO PTY . LTD

N KEY PLAN

DRAWING TITLE:
HEADWORKS - PIT & PIPE PROJECT
215 BADGERYS CREEK ROAD, BRINGELLY
BRADFIELD CITY
STAGE 1

ENABLE#:

STATE: NSW REGION:

FSA: SAM: ADA:

PROJECT No: STG-W000???

CADREF No: PN 36824

SCALE N/A SHEET No. OF REV. E

NOTES:

1. ALL PIT & PIPE INFRASTRUCTURE IS TO BE INSTALLED ACCORDING TO NBN Co's CONDUIT AND PIT NETWORK GUIDELINES (DOCUMENT NUMBER NBN-TE-CTO-194 VERSION 7.0 OR LATER).

2.  DENOTES SHARED TRENCHES

3. CONDUITS TO BE INSTALLED IN SHARED TRENCHES, BUT NOT VERTICALLY ABOVE OR BELOW OTHER UTILITIES. CONDUITS MAY BE INSTALLED WITHIN THE ENDEAVOUR ENERGY ASSET ALLOCATION SPACE IF MANDATORY RADIAL SEPARATION FROM OTHER SERVICES IS MAINTAINED AT ALL TIMES.

MINIMUM SEPARATIONS ARE:

- GAS MAIN (±ø75mm) - 150mm
- GAS MAIN (±ø110mm) - 300mm
- LV CABLES - 100mm
- HV CABLES - 300mm

REFER TYPICAL CROSS SECTION DIAGRAM.

4. NO PITS TO BE INSTALLED WITHIN 15m FROM ANY PAD MOUNTED TRANSFORMER, i.e. NO PITS TO BE INSTALLED WITHIN THE EPR (Earth Potential Rise) ZONE.

5. PITS TO BE INSTALLED CLEAR OF PROPOSED DRIVEWAYS

6. EXCLUSIVE ROAD CROSSING

7. FOR REMOVAL/RELOCATION OF EXISTING COMMS POLES & OVERHEAD NETWORK - DEVELOPER AND/OR PROJECT MANAGER IS TO LIAISE WITH:

* TELSTRA - NETWORK INTEGRITY SERVICES

PH: 1800 810 443 - NetworkIntegrity@team.telstra.com

* NBN RELOCATION WORKS GROUP

RelocationWorks@nbnco.com.au

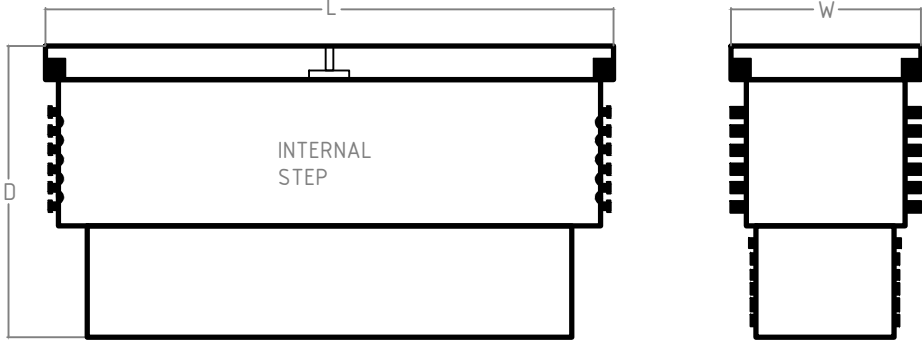

NBN NOMINAL DIMENSIONS (mm)			
PIT TYPE	L	W	D
Local Network Pit/Network Boundary Pit	700	450	650
Local Network Connection Pit	1360	555	860
Distribution Pit	1360	555	860
FDH PIT	2000	555	900

TYPICAL ROAD CROSSING CONFIGURATION
OFFSET FROM ELECTRICAL DUCTS TO ALLOW FOR SIDE ENTRY INTO PIT & CORRECT PIT PLACEMENT ON BOUNDARY.

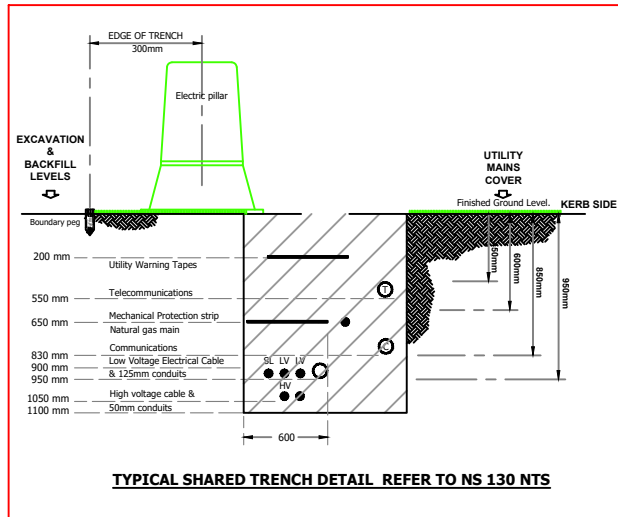
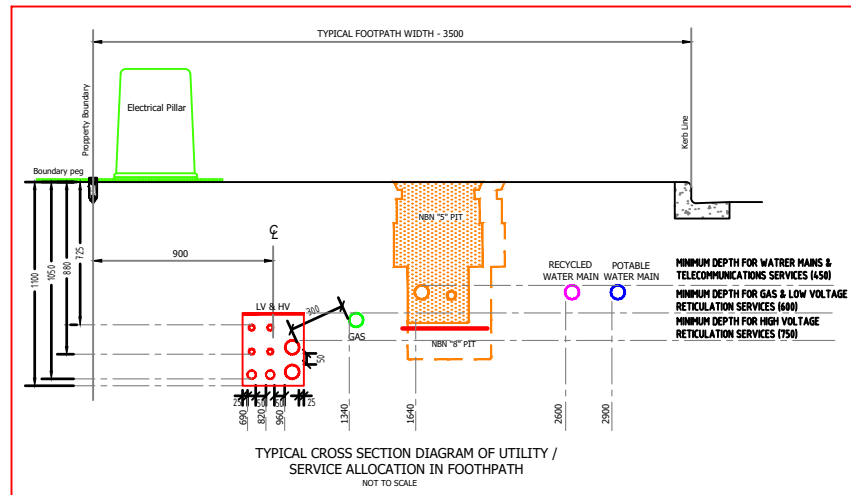
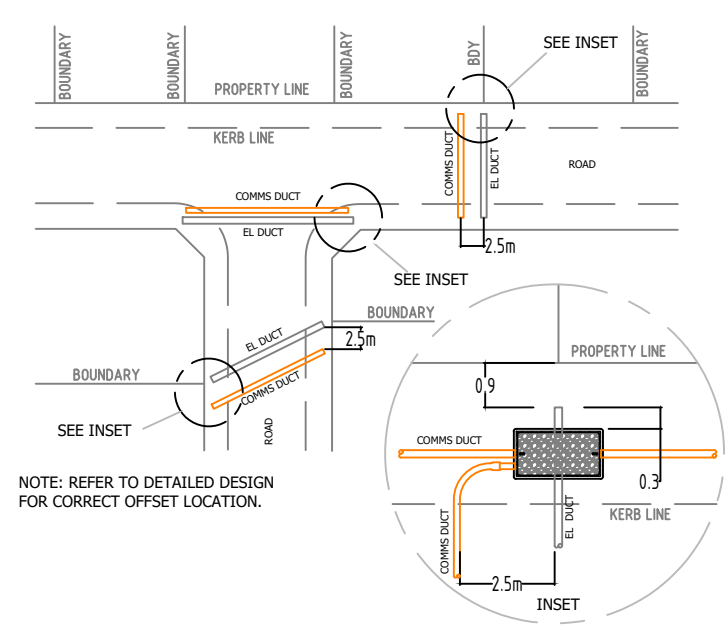

DESIGN & CONSTRUCTION AS PER
NBN GUIDELINES DOCUMENT.
* INSTALLING PIT AND CONDUIT
INFRASTRUCTURE - GUIDELINES FOR
DEVELOPERS * - 08/07/2013

CIVIL CONTRACTORS ARE NOT TO LINK INTO
EXISTING TELSTRA OR OTHER SERVICE
PROVIDER NETWORK. NEW NETWORK WILL BE
LINKED UNDER FUTURE PROJECT.
PIT AND PIPE ONLY WITH-IN THE DEVELOPMENT

SHEET 1

BADGERYS CREEK RD

SDU Development Information

Development Name:
BRADFIELD CITY
Developer Company:
SMEC
Development Address:
215 BADGERYS CREEK ROAD, BRINGELLY
Authorised Rep:
MEHUL PATEL
Phone: 02 8850 9076
E-Mail: Schatfield@bennelong.com
nbn Reference Number: STG-W000???
Stage Number: BRADFIELD STAGE 1
Design Revision: D

BILL OF MATERIAL				
NO OF LOTS: LOTS				
PITS		DUCTS		
SIZE	QTY	SIZE	QTY	MTRS
2	84	P100	P100	17049.2
5	76	P50	P50	460.9
6	0	P20	P20	588.6
8	18			
MANHOLE	31			
TOTAL NUMBER OF PITS:		205		
TOTAL NUMBER OF MANHOLES:		31		
TOTAL NUMBER OF CONDUITS:		0		
TOTAL LENGTH OF CONDUITS:		20033.5		

INNOVATION NORTH

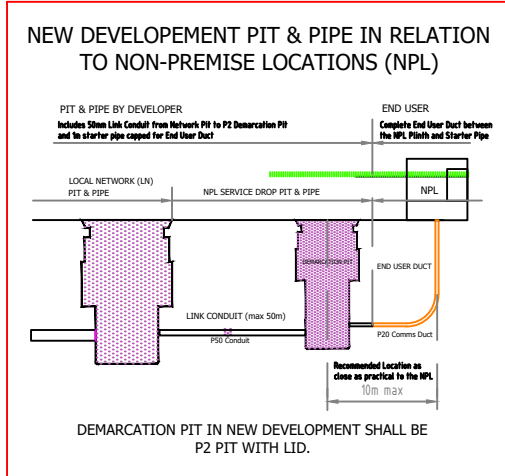
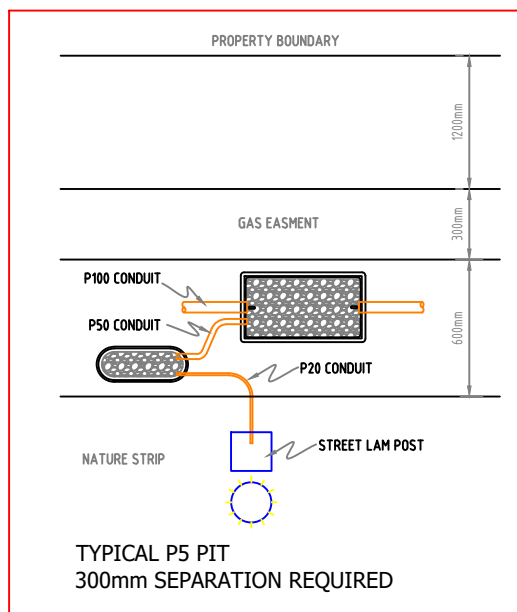

155
LOT 5
DP 243457

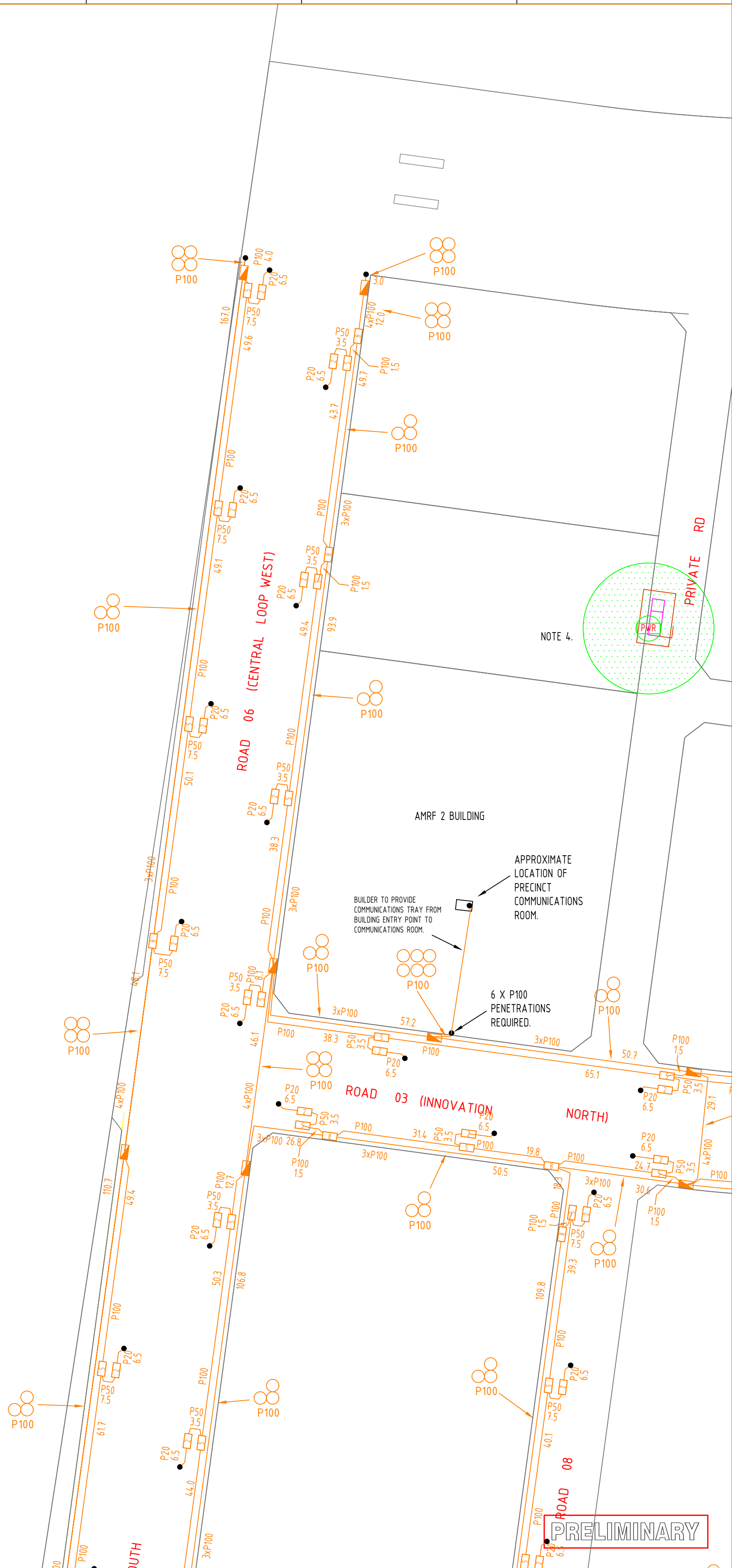

REV	DATE	DRAFTER	DESCRIPTION	APPROVED
-				
-				
-				
-E.01	06/12/2023	CIPRIAN PASCU	PRELIMINARY - CADATRE LAYOUT UPDATED ROAD 9 & 10 REMOVED LID TO AMRF	NAME
-D.01	20/11/2023	CIPRIAN PASCU	PRELIMINARY - PIT & PIPE AMENDED BOQ	NAME
-C.01	07/09/2023	CIPRIAN PASCU	PRELIMINARY - PIT & PIPE AMENDED	NAME
-B.01	15/08/2023	CIPRIAN PASCU	PRELIMINARY - UPDATED AS PER REF1	NAME
-A.01	15/08/2023	CIPRIAN PASCU	PRELIMINARY	NAME

STRICTLY CONFIDENTIAL

NBNCO APPROVAL RECORD:

SIGNATURE	DATE
<input type="checkbox"/> DD	_____
<input type="checkbox"/> WD	_____
<input type="checkbox"/> AB	_____

QUALITY RECORD :

NBNCO DISCLAIMER
THIS DOCUMENT HAS BEEN PREPARED SOLELY FOR THE USE OF NBNCO LIMITED (ABN 86 136 533 741) FOR USE IN MAINTAINING NBNCO FACILITIES. IT HAS NOT BEEN CREATED FOR ANY OTHER USE. IT SHOULD NOT BE SCALED TO LOCATE NBNCO ASSETS. NO WARRANTY IS GIVEN THAT THE INFORMATION IS ACCURATE OR COMPLETE.

DESIGN IT TELCO
PTY . LTD

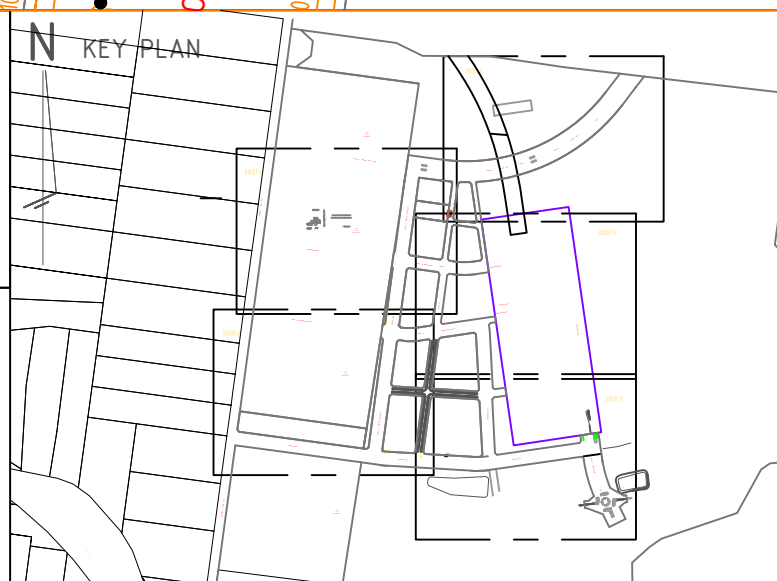

DRAWING TITLE:
HEADWORKS - PIT & PIPE PROJECT
215 BADGERYS CREEK ROAD, BRINGELLY
BRADFIELD CITY
STAGE 1

ENABLE#:

STATE: NSW	REGION:	
FSA:	SAM:	ADA:

PROJECT No: STG-W000???

CADREF No: PN 36824

SCALE N/A	SHEET No. 1 OF 5	REV. E
-----------	------------------	--------

NOTES:

1. ALL PIT & PIPE INFRASTRUCTURE IS TO BE INSTALLED ACCORDING TO NBN Co's CONDUIT AND PIT NETWORK GUIDELINES (DOCUMENT NUMBER NBN-TE-CTO-194 VERSION 7.0 OR LATER).

2.  DENOTES SHARED TRENCHES

3. CONDUITS TO BE INSTALLED IN SHARED TRENCHES, BUT NOT VERTICALLY ABOVE OR BELOW OTHER UTILITIES. CONDUITS MAY BE INSTALLED WITHIN THE ENDEAVOUR ENERGY ASSET ALLOCATION SPACE IF MANDATORY RADIAL SEPARATION FROM OTHER SERVICES IS MAINTAINED AT ALL TIMES.

MINIMUM SEPARATIONS ARE:

- GAS MAIN (±ø75mm) - 150mm
- GAS MAIN (±ø110mm) - 300mm
- LV CABLES - 100mm
- HV CABLES - 300mm

REFER TYPICAL CROSS SECTION DIAGRAM.

4. NO PITS TO BE INSTALLED WITHIN 15m FROM ANY PAD MOUNTED TRANSFORMER, i.e. NO PITS TO BE INSTALLED WITHIN THE EPR (Earth Potential Rise) ZONE.

5. PITS TO BE INSTALLED CLEAR OF PROPOSED DRIVEWAYS

6. EXCLUSIVE ROAD CROSSING

7. FOR REMOVAL/RELOCATION OF EXISTING COMMS POLES & OVERHEAD NETWORK - DEVELOPER AND/OR PROJECT MANAGER IS TO LIAISE WITH:

* TELSTRA - NETWORK INTEGRITY SERVICES

PH: 1800 810 443 - NetworkIntegrity@team.telstra.com

* NBN RELOCATION WORKS GROUP

RelocationWorks@nbnco.com.au

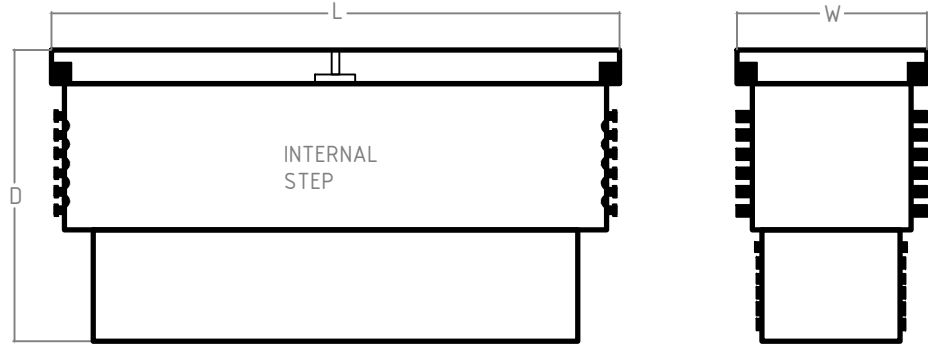

NBN NOMINAL DIMENSIONS (mm)			
PIT TYPE	L	W	D
Local Network Pit/Network Boundary Pit	700	450	650
Local Network Connection Pit	1360	555	860
Distribution Pit	1360	555	860
FDH PIT	2000	555	900

TYPICAL ROAD CROSSING CONFIGURATION
OFFSET FROM ELECTRICAL DUCTS TO ALLOW FOR SIDE ENTRY INTO PIT & CORRECT PIT PLACEMENT ON BOUNDARY.

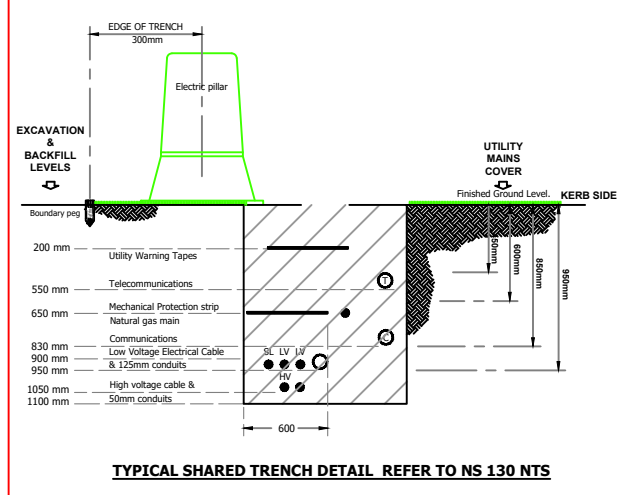
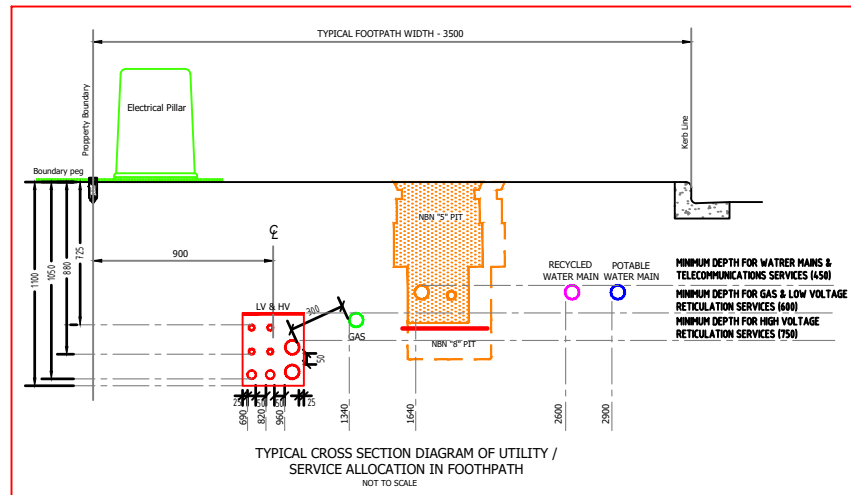
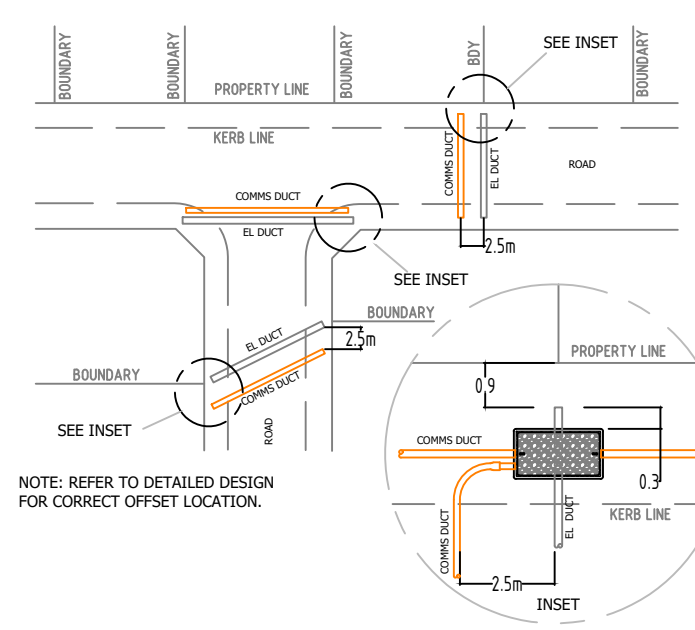

DESIGN & CONSTRUCTION AS PER
NBN GUIDELINES DOCUMENT.
* INSTALLING PIT AND CONDUIT
INFRASTRUCTURE - GUIDELINES FOR
DEVELOPERS * - 08/07/2018

CIVIL CONTRACTORS ARE NOT TO LINK INTO
EXISTING TELSTRA OR OTHER SERVICE
PROVIDER NETWORK. NEW NETWORK WILL BE
LINKED UNDER FUTURE PROJECT.
PIT AND PIPE ONLY WITH-IN THE DEVELOPMENT

SHEET 2

PRELIMINARY



REV	DATE	DRAFTER	DESCRIPTION	APPROVED
-				
-				
-E.01	06/12/2023	CIPRIAN PASCU	PRELIMINARY - CADATRE LAYOUT UPDATED ROAD 9 & 10 REMOVED LID TO AMRF	NAME
-D.01	20/11/2023	CIPRIAN PASCU	PRELIMINARY - PIT & PIPE AMENDED BOQ	NAME
-C.01	07/09/2023	CIPRIAN PASCU	PRELIMINARY - PIT & PIPE AMENDED	NAME
-B.01	15/08/2023	CIPRIAN PASCU	PRELIMINARY - UPDATED AS PER REF1	NAME
-A.01	15/08/2023	CIPRIAN PASCU	PRELIMINARY	NAME

STRICTLY CONFIDENTIAL

NBNCO APPROVAL RECORD:

SIGNATURE		DATE
<input type="checkbox"/> DD	_____	_____
<input type="checkbox"/> WD	_____	_____
<input type="checkbox"/> AB	_____	_____

QUALITY RECORD :

NBNCO DISCLAIMER

THIS DOCUMENT HAS BEEN PREPARED SOLELY FOR THE USE OF NBNCO LIMITED (ABN 86 136 533 741) FOR USE IN MAINTAINING NBNCO FACILITIES. IT HAS NOT BEEN CREATED FOR ANY OTHER USE. IT SHOULD NOT BE SCALED TO LOCATE NBNCO ASSETS. NO WARRANTY IS GIVEN THAT THE INFORMATION IS ACCURATE OR COMPLETE.

DESIGN IT TELCO
PTY . LTD

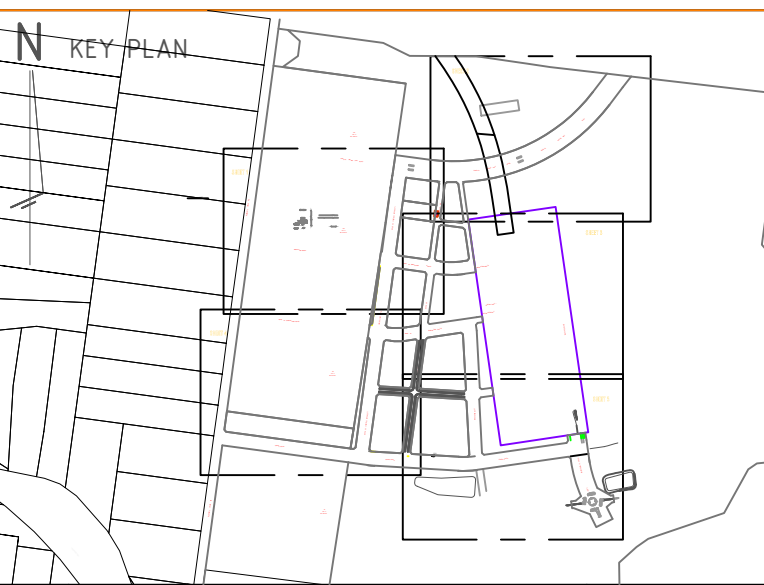

DRAWING TITLE:
HEADWORKS - PIT & PIPE PROJECT
215 BADGERYS CREEK ROAD, BRINGELLY
BRADFELD CITY
STAGE 1

ENABLE#:		
STATE: NSW	REGION:	
FSA:	SAM:	ADA:
PROJECT No: STG-W000???		
CADREF No: PN 36824		
SCALE N/A	SHEET No. 2 OF 5	REV. E

NOTES:

1. ALL PIT & PIPE INFRASTRUCTURE IS TO BE INSTALLED ACCORDING TO NBN Co's CONDUIT AND PIT NETWORK GUIDELINES (DOCUMENT NUMBER NBN-TE-CTO-194 VERSION 7.0 OR LATER).

2.  DENOTES SHARED TRENCHES

3. CONDUITS TO BE INSTALLED IN SHARED TRENCHES, BUT NOT VERTICALLY ABOVE OR BELOW OTHER UTILITIES. CONDUITS MAY BE INSTALLED WITHIN THE ENDEAVOUR ENERGY ASSET ALLOCATION SPACE IF MANDATORY RADIAL SEPARATION FROM OTHER SERVICES IS MAINTAINED AT ALL TIMES. MINIMUM SEPARATIONS ARE:
- GAS MAIN (±ø75mm) - 150mm
- GAS MAIN (±ø110mm) - 300mm
- LV CABLES - 100mm
- HV CABLES - 300mm
REFER TYPICAL CROSS SECTION DIAGRAM.

4. NO PITS TO BE INSTALLED WITHIN 15m FROM ANY PAD MOUNTED TRANSFORMER, i.e. NO PITS TO BE INSTALLED WITHIN THE EPR (Earth Potential Rise) ZONE.

5. PITS TO BE INSTALLED CLEAR OF PROPOSED DRIVEWAYS

6. EXCLUSIVE ROAD CROSSING

7. FOR REMOVAL/RELOCATION OF EXISTING COMMS POLES & OVERHEAD NETWORK - DEVELOPER AND/OR PROJECT MANAGER IS TO LIAISE WITH:

* TELSTRA - NETWORK INTEGRITY SERVICES
PH: 1800 810 443 - NetworkIntegrity@team.telstra.com
* NBN RELOCATION WORKS GROUP
RelocationWorks@nbnco.com.au

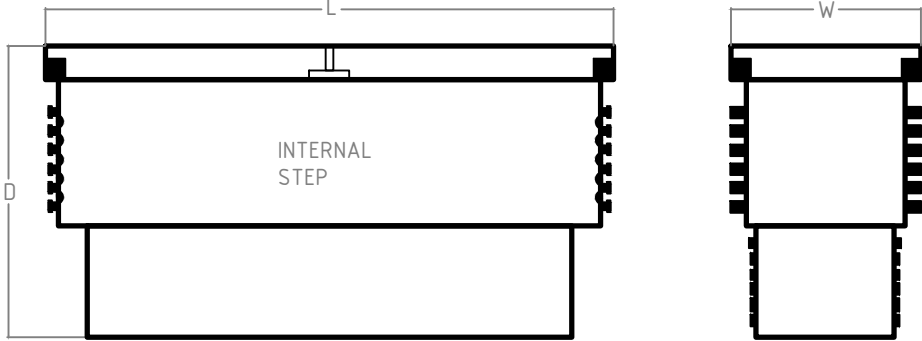

NBN NOMINAL DIMENSIONS (mm)			
PIT TYPE	L	W	D
Local Network Pit/Network Boundary Pit	700	450	650
Local Network Connection Pit	1360	555	860
Distribution Pit	1360	555	860
FDH PIT	2000	555	900

TYPICAL ROAD CROSSING CONFIGURATION
OFFSET FROM ELECTRICAL DUCTS TO ALLOW FOR SIDE ENTRY INTO PIT & CORRECT PIT PLACEMENT ON BOUNDARY.

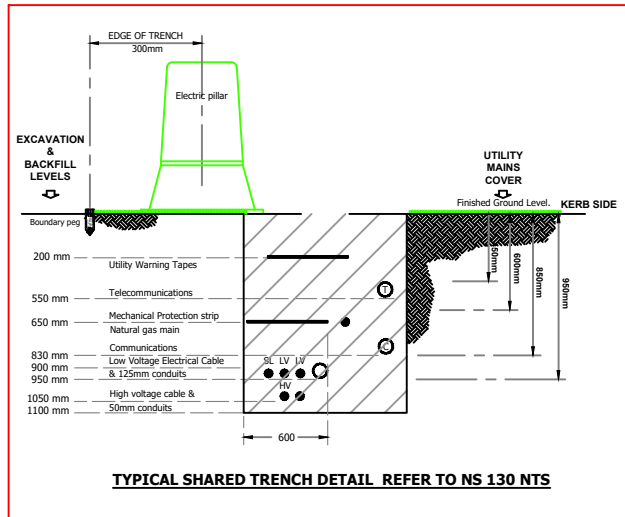
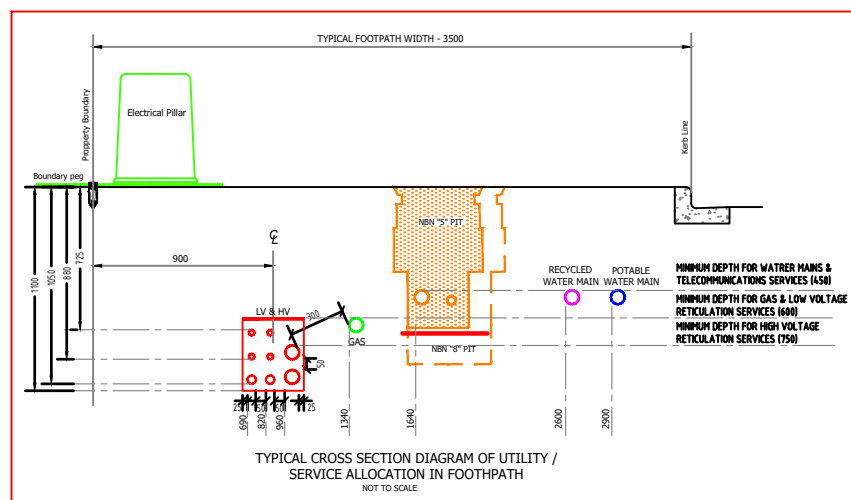
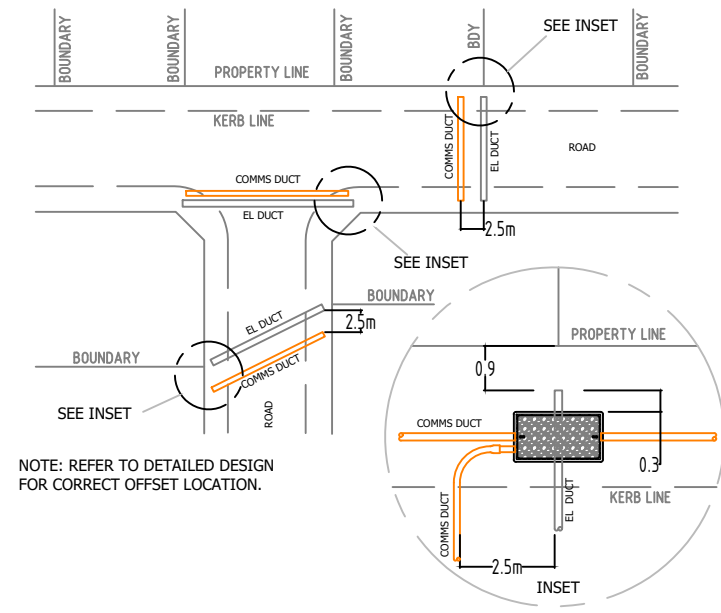

DESIGN & CONSTRUCTION AS PER NBN GUIDELINES DOCUMENT.
* INSTALLING PIT AND CONDUIT INFRASTRUCTURE - GUIDELINES FOR DEVELOPERS * - 08/07/2018

CIVIL CONTRACTORS ARE NOT TO LINK INTO EXISTING TELSTRA OR OTHER SERVICE PROVIDER NETWORK. NEW NETWORK WILL BE LINKED UNDER FUTURE PROJECT.
PIT AND PIPE ONLY WITH-IN THE DEVELOPMENT

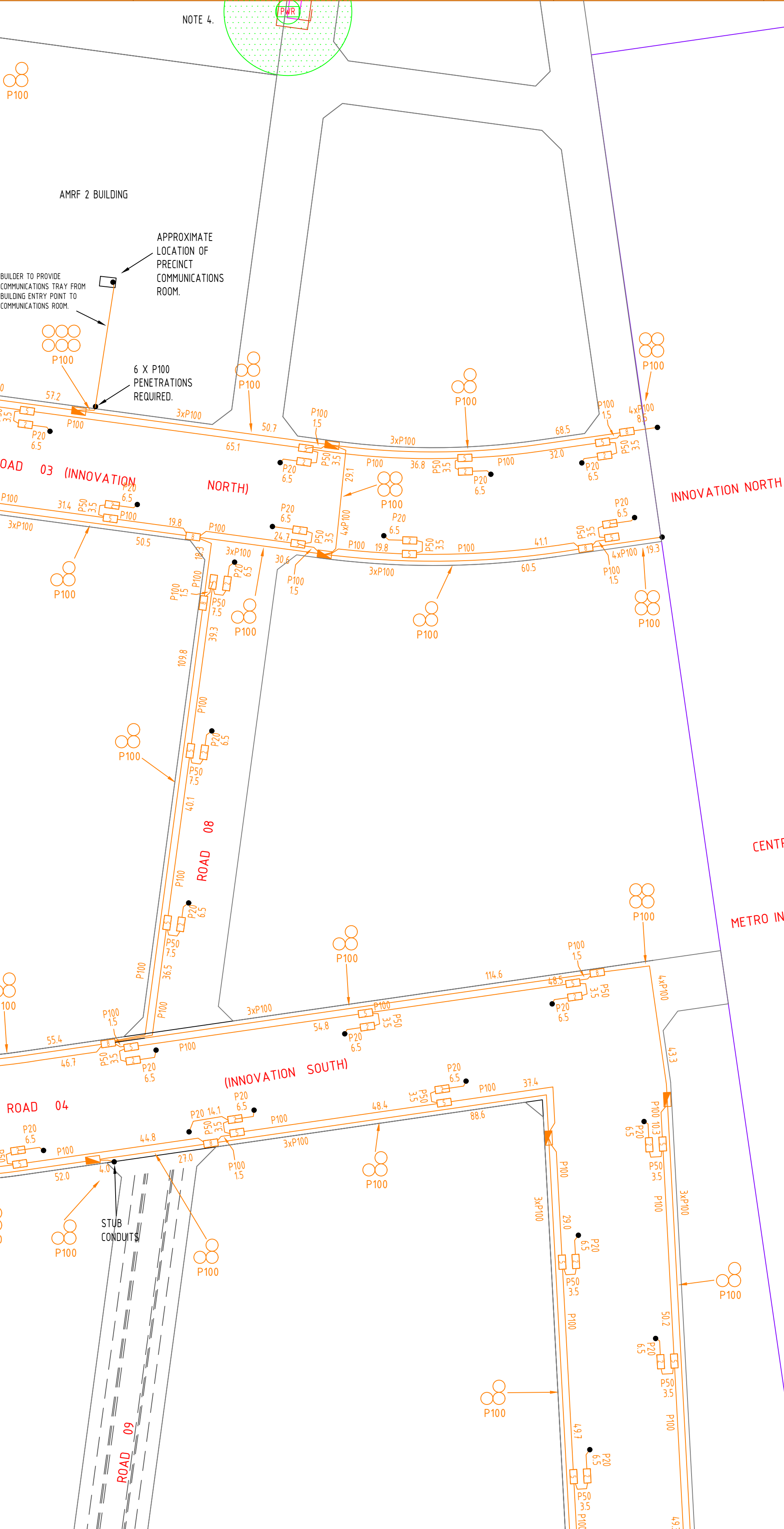

CENTRAL PARK /
METRO INTERFACE

INNOVATION EAST

SHEET 3

PRELIMINARY

STRICTLY CONFIDENTIAL

NBNCO APPROVAL RECORD:

SIGNATURE	DATE
<input type="checkbox"/> DD	_____
<input type="checkbox"/> WD	_____
<input type="checkbox"/> AB	_____

QUALITY RECORD :

NBNCO DISCLAIMER
THIS DOCUMENT HAS BEEN PREPARED SOLELY FOR THE USE OF NBNCO LIMITED (ABN 86 136 533 741) FOR USE IN MAINTAINING NBNCO FACILITIES. IT HAS NOT BEEN CREATED FOR ANY OTHER USE. IT SHOULD NOT BE SCALED TO LOCATE NBNCO ASSETS. NO WARRANTY IS GIVEN THAT THE INFORMATION IS ACCURATE OR COMPLETE.

DESIGN IT TELCO
PTY . LTD

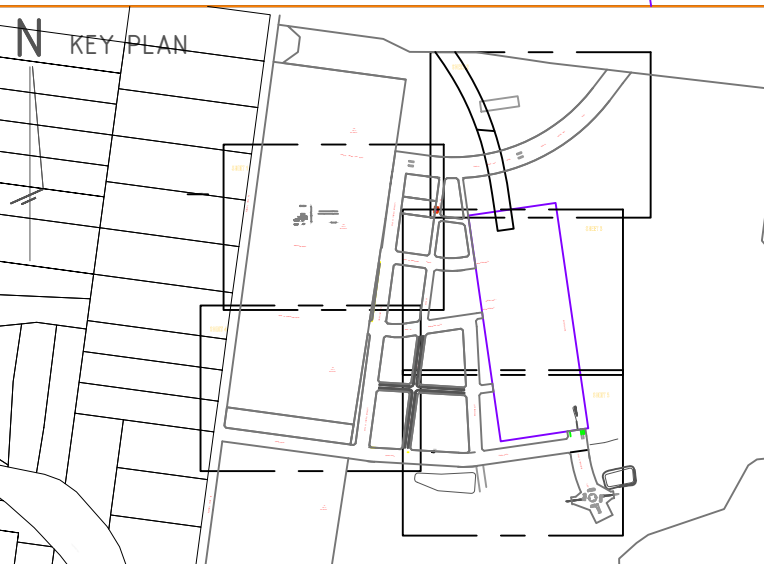

DRAWING TITLE:
HEADWORKS - PIT & PIPE PROJECT
215 BADGERYS CREEK ROAD, BRINGELLY
BRADFELD CITY
STAGE 1

ENABLE#:		
STATE: NSW	REGION:	
FSA:	SAM:	ADA:
PROJECT No:	STG-W000???	
CADREF No:	PN 36824	
SCALE N/A	SHEET No. 3 OF 5	REV. E

NOTES:

1. ALL PIT & PIPE INFRASTRUCTURE IS TO BE INSTALLED ACCORDING TO NBN Co's CONDUIT AND PIT NETWORK GUIDELINES (DOCUMENT NUMBER NBN-TE-CTO-194 VERSION 7.0 OR LATER).

2.  DENOTES SHARED TRENCHES

3. CONDUITS TO BE INSTALLED IN SHARED TRENCHES, BUT NOT VERTICALLY ABOVE OR BELOW OTHER UTILITIES. CONDUITS MAY BE INSTALLED WITHIN THE ENDEAVOUR ENERGY ASSET ALLOCATION SPACE IF MANDATORY RADIAL SEPARATION FROM OTHER SERVICES IS MAINTAINED AT ALL TIMES.

MINIMUM SEPARATIONS ARE:

- GAS MAIN (±ø75mm) - 150mm
- GAS MAIN (±ø110mm) - 300mm
- LV CABLES - 100mm
- HV CABLES - 300mm

REFER TYPICAL CROSS SECTION DIAGRAM.

4. NO PITS TO BE INSTALLED WITHIN 15m FROM ANY PAD MOUNTED TRANSFORMER, i.e. NO PITS TO BE INSTALLED WITHIN THE EPR (Earth Potential Rise) ZONE.

5. PITS TO BE INSTALLED CLEAR OF PROPOSED DRIVEWAYS

6. EXCLUSIVE ROAD CROSSING

7. FOR REMOVAL/RELOCATION OF EXISTING COMMS POLES & OVERHEAD NETWORK - DEVELOPER AND/OR PROJECT MANAGER IS TO LIAISE WITH:

- * TELSTRA - NETWORK INTEGRITY SERVICES
PH: 1800 810 443 - NetworkIntegrity@team.telstra.com
- * NBN RELOCATION WORKS GROUP
RelocationWorks@nbnco.com.au

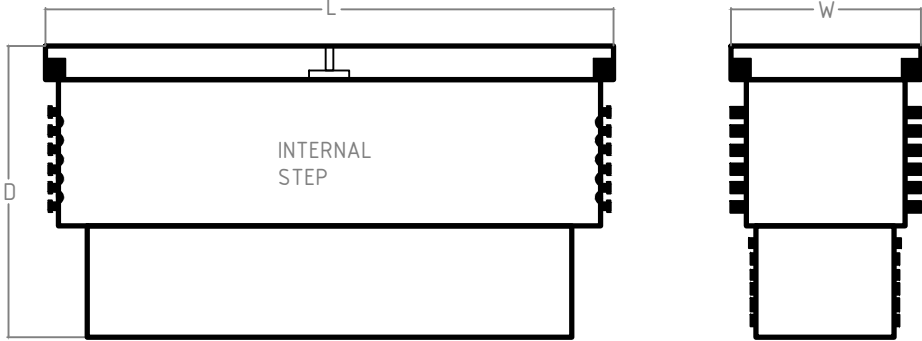

NBN NOMINAL DIMENSIONS (mm)			
PIT TYPE	L	W	D
Local Network Pit/Network Boundary Pit	700	450	650
Local Network Connection Pit	1360	555	860
Distribution Pit	1360	555	860
FDH PIT	2000	555	900

TYPICAL ROAD CROSSING CONFIGURATION
OFFSET FROM ELECTRICAL DUCTS TO ALLOW FOR SIDE ENTRY INTO PIT & CORRECT PIT PLACEMENT ON BOUNDARY.

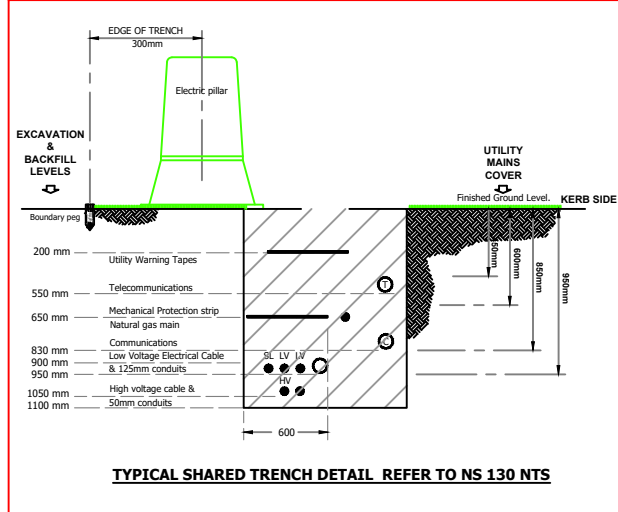
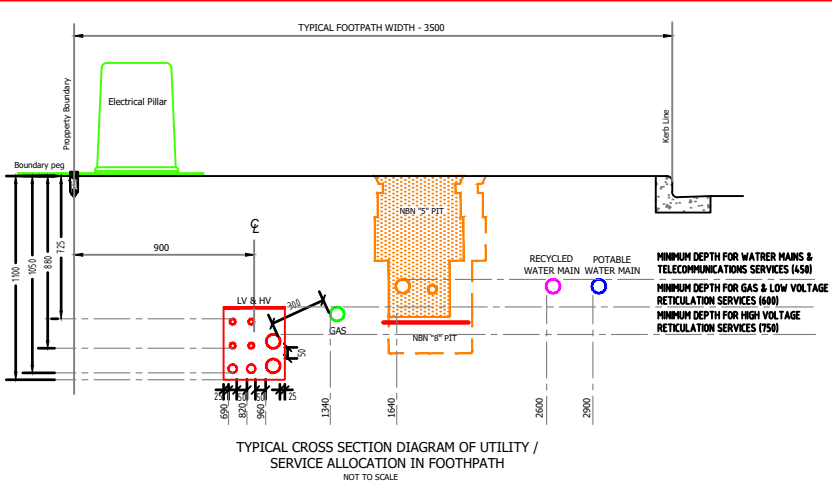
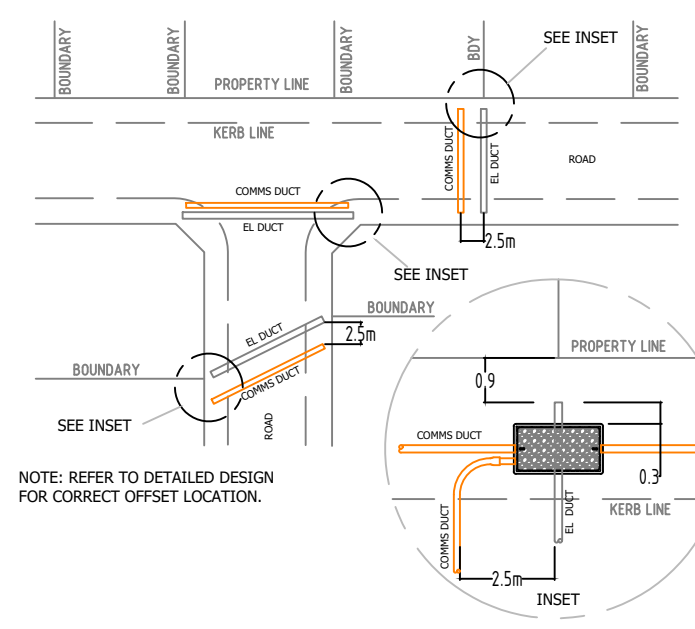

DESIGN & CONSTRUCTION AS PER
NBN GUIDELINES DOCUMENT.
* INSTALLING PIT AND CONDUIT
INFRASTRUCTURE - GUIDELINES FOR
DEVELOPERS * - 08/07/2013

CIVIL CONTRACTORS ARE NOT TO LINK INTO
EXISTING TELSTRA OR OTHER SERVICE
PROVIDER NETWORK. NEW NETWORK WILL BE
LINKED UNDER FUTURE PROJECT.
PIT AND PIPE ONLY WITH-IN THE DEVELOPMENT

SHEET 4

ROAD 07 (INNOVATION SOUTH)

115
LOT 1
DP 244.113

CENTRE SOUTH

ROAD 06 (CENTRAL LOOP WEST)

CENTRE SOUTH

PRELIMINARY



REV	DATE	DRAFTER	DESCRIPTION	APPROVED
-				
-				
-E.01	06/12/2023	CIPRIAN PASCU	PRELIMINARY - CADATRE LAYOUT UPDATED ROAD 9 & 10 REMOVED LID TO AMRF	NAME
-D.01	20/11/2023	CIPRIAN PASCU	PRELIMINARY - PIT & PIPE AMENDED BOQ	NAME
-C.01	07/09/2023	CIPRIAN PASCU	PRELIMINARY - PIT & PIPE AMENDED	NAME
-B.01	15/08/2023	CIPRIAN PASCU	PRELIMINARY - UPDATED AS PER REF1	NAME
-A.01	15/08/2023	CIPRIAN PASCU	PRELIMINARY	NAME

STRICTLY CONFIDENTIAL

NBNCO APPROVAL RECORD:

SIGNATURE	DATE
<input type="checkbox"/> DD	_____
<input type="checkbox"/> WD	_____
<input type="checkbox"/> AB	_____

QUALITY RECORD :

NBNCO DISCLAIMER

THIS DOCUMENT HAS BEEN PREPARED SOLELY FOR THE USE OF NBNCO LIMITED (ABN 86 136 533 741) FOR USE IN MAINTAINING NBNCO FACILITIES. IT HAS NOT BEEN CREATED FOR ANY OTHER USE. IT SHOULD NOT BE SCALED TO LOCATE NBNCO ASSETS. NO WARRANTY IS GIVEN THAT THE INFORMATION IS ACCURATE OR COMPLETE.

DESIGN IT TELCO
PTY . LTD

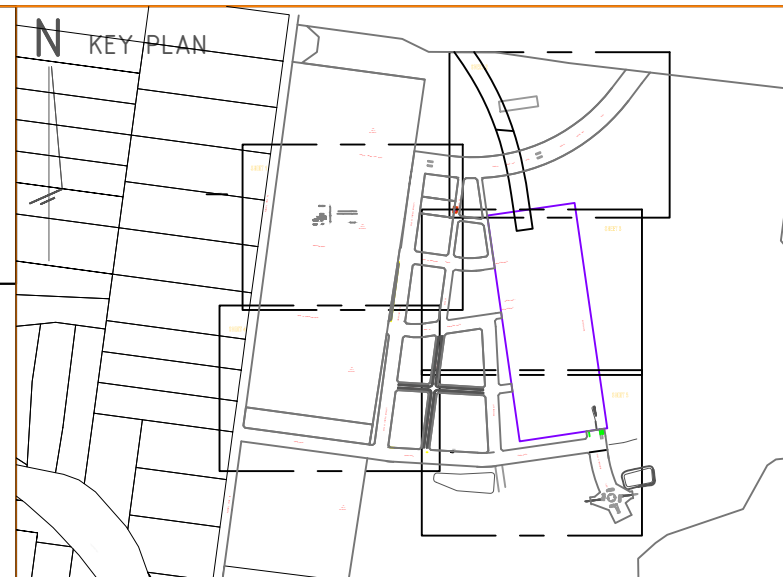

DRAWING TITLE:

HEADWORKS - PIT & PIPE PROJECT
215 BADGERYS CREEK ROAD, BRINGELLY
BRADFELD CITY
STAGE 1

ENABLE#:

STATE: NSW

REGION:

FSA:

SAM:

ADA:

PROJECT No:

STG-W000???

CADREF No:

PN 36824

SCALE

N/A

SHEET No.

4

OF

5

REV.

E

NOTES:

1. ALL PIT & PIPE INFRASTRUCTURE IS TO BE INSTALLED ACCORDING TO NBN Co's CONDUIT AND PIT NETWORK GUIDELINES (DOCUMENT NUMBER NBN-TE-CTO-194 VERSION 7.0 OR LATER).

2.  DENOTES SHARED TRENCHES

3. CONDUITS TO BE INSTALLED IN SHARED TRENCHES, BUT NOT VERTICALLY ABOVE OR BELOW OTHER UTILITIES. CONDUITS MAY BE INSTALLED WITHIN THE ENDEAVOUR ENERGY ASSET ALLOCATION SPACE IF MANDATORY RADIAL SEPARATION FROM OTHER SERVICES IS MAINTAINED AT ALL TIMES. MINIMUM SEPARATIONS ARE:
- GAS MAIN (±ø75mm) - 150mm
- GAS MAIN (±ø110mm) - 300mm
- LV CABLES - 100mm
- HV CABLES - 300mm
REFER TYPICAL CROSS SECTION DIAGRAM.

4. NO PITS TO BE INSTALLED WITHIN 15m FROM ANY PAD MOUNTED TRANSFORMER, i.e. NO PITS TO BE INSTALLED WITHIN THE EPR (Earth Potential Rise) ZONE.

5. PITS TO BE INSTALLED CLEAR OF PROPOSED DRIVEWAYS

6. EXCLUSIVE ROAD CROSSING

7. FOR REMOVAL/RELOCATION OF EXISTING COMMS POLES & OVERHEAD NETWORK - DEVELOPER AND/OR PROJECT MANAGER IS TO LIAISE WITH:

* TELSTRA - NETWORK INTEGRITY SERVICES
PH: 1800 810 443 - NetworkIntegrity@team.telstra.com
* NBN RELOCATION WORKS GROUP
RelocationWorks@nbnco.com.au

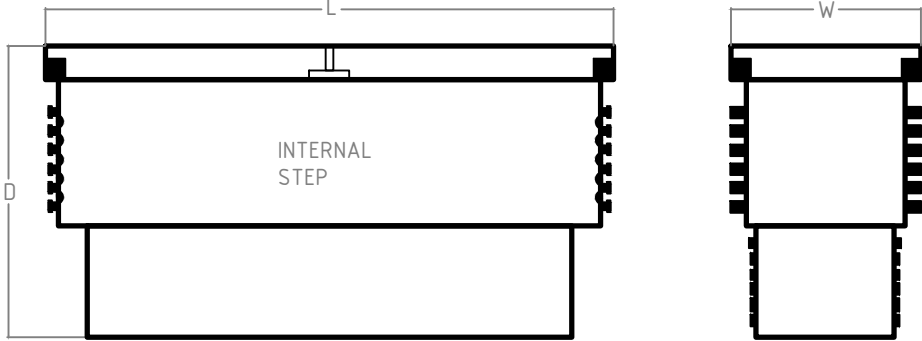

NBN NOMINAL DIMENSIONS (mm)			
PIT TYPE	L	W	D
Local Network Pit/Network Boundary Pit	700	450	650
Local Network Connection Pit	1360	555	860
Distribution Pit	1360	555	860
FDH PIT	2000	555	900

TYPICAL ROAD CROSSING CONFIGURATION
OFFSET FROM ELECTRICAL DUCTS TO ALLOW FOR SIDE ENTRY INTO PIT & CORRECT PIT PLACEMENT ON BOUNDARY.

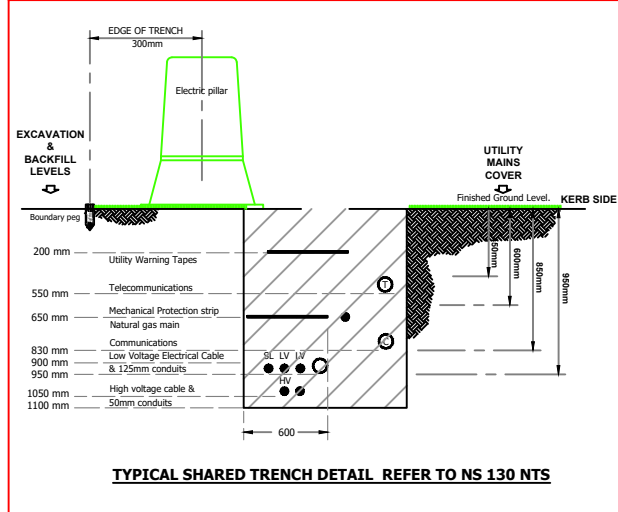
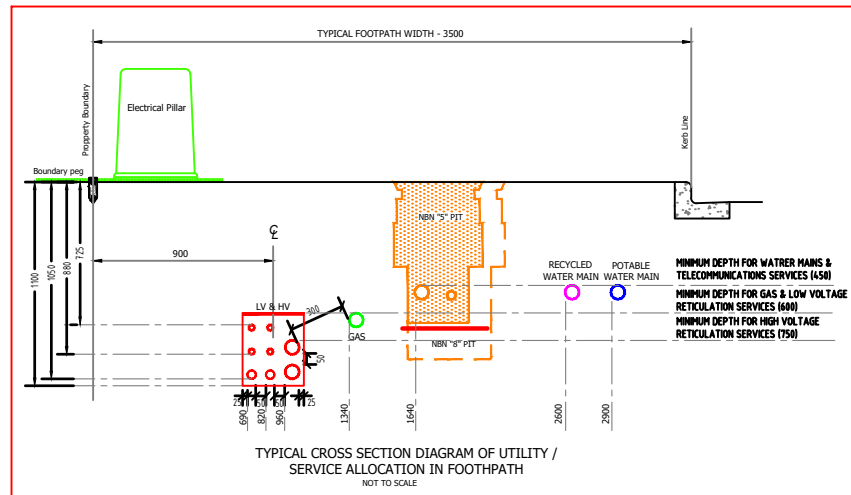
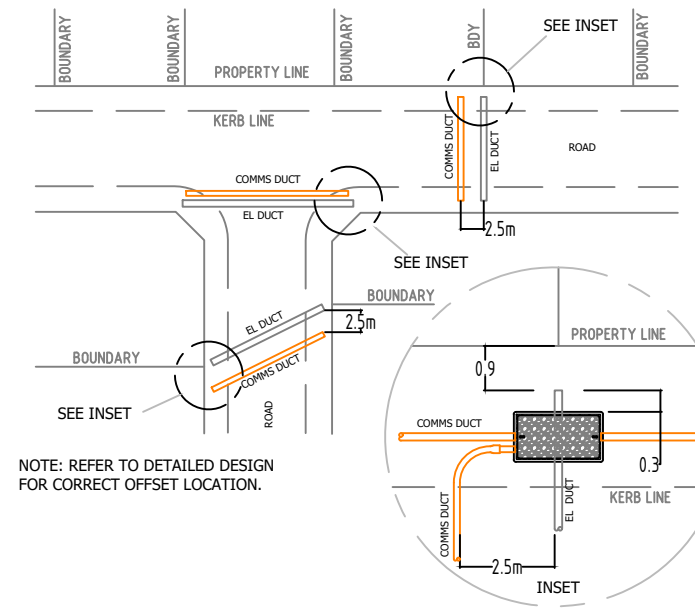

DESIGN & CONSTRUCTION AS PER
NBN GUIDELINES DOCUMENT.
* INSTALLING PIT AND CONDUIT
INFRASTRUCTURE - GUIDELINES FOR
DEVELOPERS * - 08/07/2013

CIVIL CONTRACTORS ARE NOT TO LINK INTO
EXISTING TELSTRA OR OTHER SERVICE
PROVIDER NETWORK. NEW NETWORK WILL BE
LINKED UNDER FUTURE PROJECT.
PIT AND PIPE ONLY WITH-IN THE DEVELOPMENT



REV	DATE	DRAFTER	DESCRIPTION	APPROVED
-				
-				
-E.01	06/12/2023	CIPRIAN PASCU	PRELIMINARY - CADATRE LAYOUT UPDATED ROAD 9 & 10 REMOVED LID TO AMRF	NAME
-D.01	20/11/2023	CIPRIAN PASCU	PRELIMINARY - PIT & PIPE AMENDED BOQ	NAME
-C.01	07/09/2023	CIPRIAN PASCU	PRELIMINARY - PIT & PIPE AMENDED	NAME
-B.01	15/08/2023	CIPRIAN PASCU	PRELIMINARY - UPDATED AS PER REF1	NAME
-A.01	15/08/2023	CIPRIAN PASCU	PRELIMINARY	NAME

STRICTLY CONFIDENTIAL

NBNCO APPROVAL RECORD:

SIGNATURE	DATE
<input type="checkbox"/> DD	_____
<input type="checkbox"/> WD	_____
<input type="checkbox"/> AB	_____

QUALITY RECORD :

NBNCO DISCLAIMER

THIS DOCUMENT HAS BEEN PREPARED SOLELY FOR THE USE OF NBNCO LIMITED (ABN 86 136 533 741) FOR USE IN MAINTAINING NBNCO FACILITIES. IT HAS NOT BEEN CREATED FOR ANY OTHER USE. IT SHOULD NOT BE SCALED TO LOCATE NBNCO ASSETS. NO WARRANTY IS GIVEN THAT THE INFORMATION IS ACCURATE OR COMPLETE.

DESIGN IT TELCO
PTY . LTD

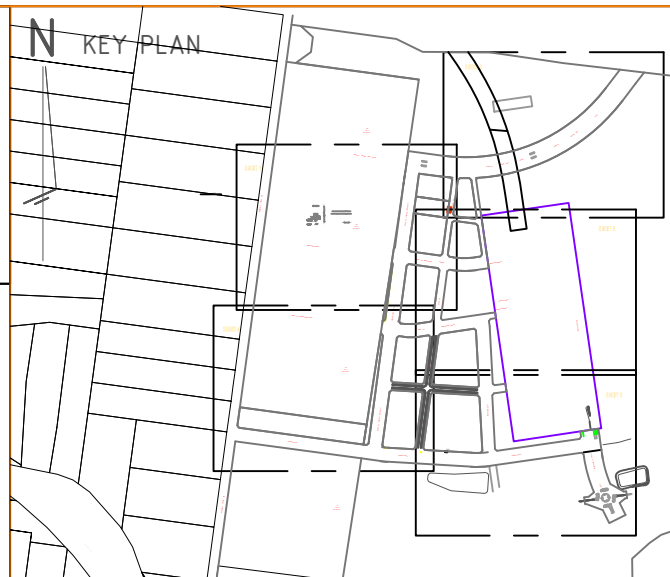

DRAWING TITLE:
HEADWORKS - PIT & PIPE PROJECT
215 BADGERYS CREEK ROAD, BRINGELLY
BRADFIELD CITY
STAGE 1

ENABLE#:		
STATE:	NSW	REGION:
FSA:	SAM:	ADA:
PROJECT No:	STG-W000???	
CADREF No:	PN 36824	
SCALE	SHEET No.	REV.
N/A	5 OF 5	E